

# LIBRARY RENOVATION



**Owner:**  
Wilmington Friends School

**Project Location:**  
Wilmington, DE

**Size:**  
18,500 SF

**Cost:**  
\$3.8M - Project  
\$3.5M - Building  
\$300K - Site

**Building Use:**  
Academic

**Delivery System:**  
Construction Management

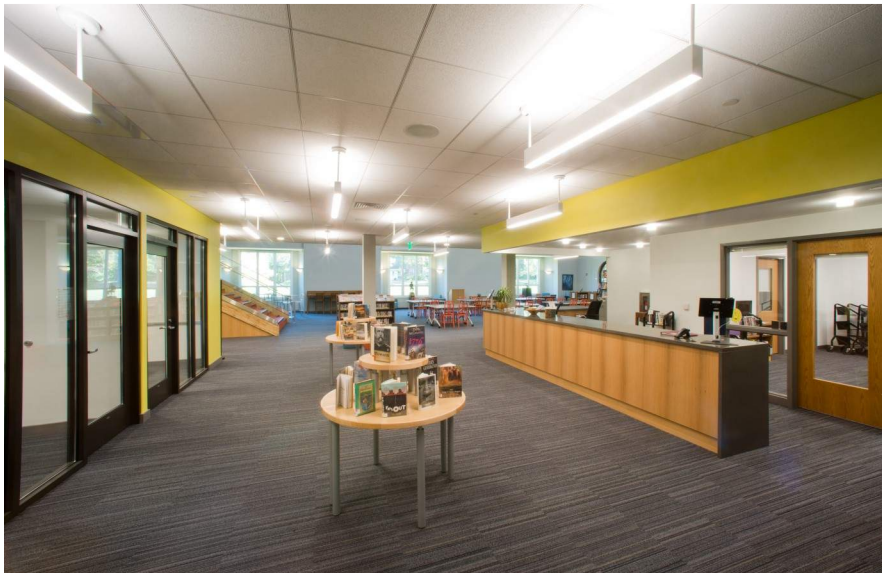

**Project Completion:**  
2015

**Architect:**  
DIGSAU

**Description:**  
When Nowland Associates completed the original construction of the Wilmington Friend's Library in 1971, the project increased the size of campus facilities by 33%.

In 2015, in conjunction with the Global Learning Center project, Nowland Associates was charged with overhauling the original Library. Renovations included reducing stack areas to create collaboration spaces, installing global classrooms, updating finishes and retrofitting existing lighting fixtures with LED technology. The overall design and construction of the project resulted in a net-zero energy building.

